

C 空心杯电机 Coreless Motor		
额定电压/Nominal voltage	24	V
空载转速/No-load speed (±10%)	2320	rpm
空载电流/No-load current (max)	62.1	mA
额定转速/Nominal speed	1861	rpm
最大连续转矩/Max. continuous torque (motor thermal limit)	38.3	mNm
最大连续电流/Max. continuous current (motor thermal limit)	0.507	A
堵转转矩/Stall torque	0.20	Nm
堵转电流/Stall current	2.47	A
环境温度范围/Ambient temperature	-40~+85	℃
绝缘等级/Insulation class	B	
重量/Weight	113.1	g
端电阻/Terminal resistance (motor) (±8%)	9.7	Ω
转矩常数/Torque constant (motor) (±8%)	24.49	mNm/A
转速常数/Speed constant (motor) (±8%)	390	rpm/V
转速/转矩斜率/Speed/torque gradient (motor)	155	rpm/mNm
电机空载转速/No-load speed (motor)	9600	rpm
电刷类型/Brushes type (motor)	Graphite brushes	
轴承类型/Bearing type (motor)	Ball bearing	
轴向间隙/Axial play (gearhead)	≤0.35	mm
级数/Number of stages (gearhead)	1	
减速比/Reduction ratio (gearhead)	4:1	
效率/Efficiency (gearhead)	84%	

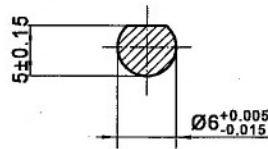

A-A

受控文件
 日期 2023-07-03
 鸣志电器(太仓)有限公司

铭牌/Label Detail

MOONS'	
Motor Type	DCU24032G24-S102
Gearbox Type	PG22C-0004
Work Order	XXXXXXXX YYYY
Serial No.	

备注：二维码内包含产品名称、工单号、序列号。

REV.	版本记录 REVISION RECORD	DATE
A0	原始版本 Original revision	2023.06.05

Unit: mm
 第一角画法
 FIRST ANGLE METHOD

未注线性与角度尺寸公差
 Tolerances for linear and angular dimensions
 without individual tolerance indications
 GB/T 1804-m eqv ISO 2768-1: m

未注形状与位置尺寸公差
 Geometrical tolerance for features without
 individual tolerance indications
 GB/T 1184-K eqv ISO 2768-2: K

批准 Approve	标准化 Standardize	工艺 Process Review	审核 Check	设计 Design

MOONS'
moving in better ways

This document is released for information only. Its reproduction in whole or in part or its dissemination to third parties is prohibited. All trademarks and registered trademarks appearing on this document are the property of their respective owners.

Drawing No: 4611185000463 Rev.A0 SCALE 2:1 Sheet 1 of 1