

DCU24032G24-S101

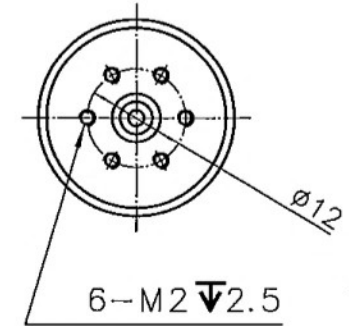
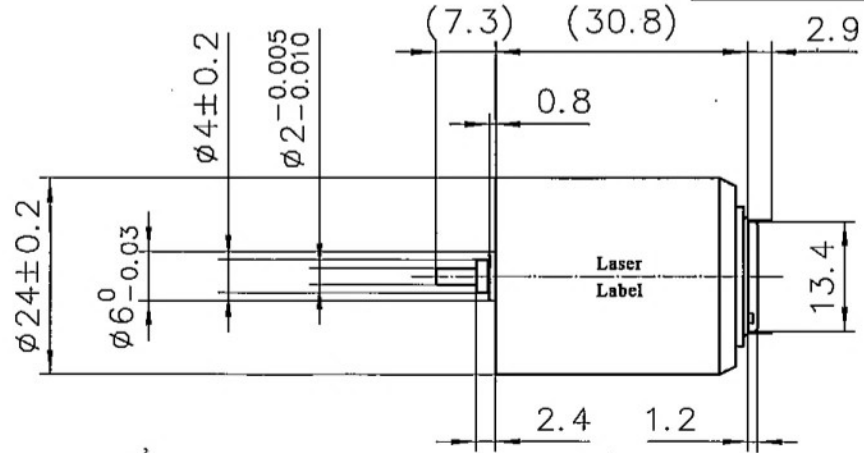
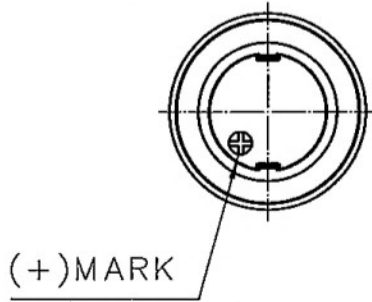

规格/Specification		
额定电压/Nominal voltage	24	V
空载转速/No-load speed (±10%)	9630	rpm
空载电流/No-load current (max)	31.5	mA
额定转速/Nominal speed	7750	rpm
最大连续转矩/Max. continuous torque	11.84	mNm
最大连续电流/Max. continuous current	0.52	A
堵转转矩/Stall torque	61.44	mNm
堵转电流/Stall current	2.61	A
最大效率/Max. efficiency	84%	
端电阻/Terminal resistance (±8%)	9.2	Ω
端电感/Terminal inductance	0.293	mH
转矩常数/Torque constant (±8%)	23.5	mNm/A
转速常数/Speed constant (±8%)	405	rpm/V
转速/转矩斜率/Speed/torque gradient	159	rpm/mNm
机械时间常数/Mechanical time constant	5.31	ms
转子惯量/Rotor inertia	3.490	gcm ²
环境温度范围/Ambient temperature	-40~+85	℃
绝缘等级/Insulation class	B	
绕组最高温度/Max. winding temperature	125	℃
轴承/Bearing	Ball bearing	
轴向间隙/Axial play	≤0.3	mm
电刷类型/Brushes type	Graphite brushes	
换向器片数/Number of commutator segments	5	
重量/Weight	79	g

受控文件
日期 2023-01-17
鸣志电器(太仓)有限公司

铭牌/Label Detail

MOONS'	
Motor Type	DCU24032G24-S101
Work Order	XXXXXXXX YYYY
Serial No.	

备注：二维码内包含产品名称、工单号、序列号。

A0	原始版本 Original revision	2023.1.16
REV.	版本记录 REVISION RECORD	DATE

Unit: mm 第一角画法 FIRST ANGLE METHOD	批准 Approve	
未注线性与角度尺寸公差 Tolerances for linear and angular dimensions without individual tolerance indications GB/T 1804-m eqv ISO 2768-1: m	标准化 Standardize	
未注形状与位置尺寸公差 Geometrical tolerance for features without individual tolerance indications GB/T 1184-K eqv ISO 2768-2: K	工艺 Process Review	
	审核 Check	
	设计 Design	
UNLESS OTHERWISE SPECIFIED	NAMES	SIGNATURE DATE

MOONS'
moving in better ways

This document is released for information only. Its reproduction in whole or in part or its dissemination to third parties is prohibited. All trademarks and registered trademarks appearing on this document are the property of their respective owners.

Drawing No: 4611185000483 Rev.A0 SCALE2:1 Sheet 1 of 1